

VR SERIES

AUTOMOTIVE RELAY SOCKETS

DESCRIPTION

5 Pin Automotive Micro Relay Sockets

CONSTRUCTION

- Contacts** • Brass, Bright Tin Plated
Molding • Heat Stabilized Thermoplastic, 130° C Continuous use temperature rating

ORDERING CODE

PART NO.	DESCRIPTION	TERMINAL TYPE
VR04-PCB-0	4 Pin Automotive (Fig. 1)	PC Board
VR05-PCB	5 Pin Automotive (Fig. 2)	PC Board
VR05-SPCB	5 Pin Automotive (Fig. 2)	PC Board
VR05-LFW	5 Pin Automotive (Fig. 3)	Crimp (see chart)
VR05-FW	5 Pin Automotive (Fig. 4)	Crimp (see chart)

TERMINAL COMPATIBILITY CHART

Custom Connector Corporation recommends the following terminals to be used in conjunction with our BR Series relay socket series. All Parts listed below need to be purchased separately.

ORDER FROM	PART NO.	AWG	BLADE
FCI Automotive	JW-1230-2	12-14	1/4"
FCI Automotive	JW-1630-2	16-18	1/4"
AMP	42100	14-18	1/4"
AMP	42281	14-18	1/4"
AMP	42904	12-16	1/4"
AMP	60249	12-16	1/4"
Grote & Hartmann	26313	18	3/16"

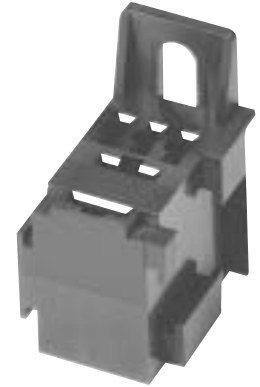

Fig. 1 PC BOARD LAYOUT

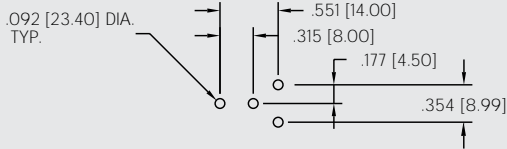

Fig. 2 PC BOARD LAYOUT

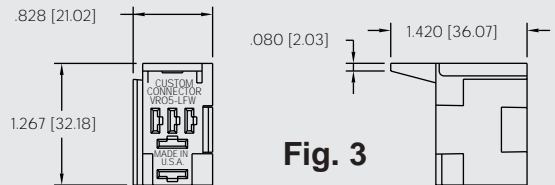
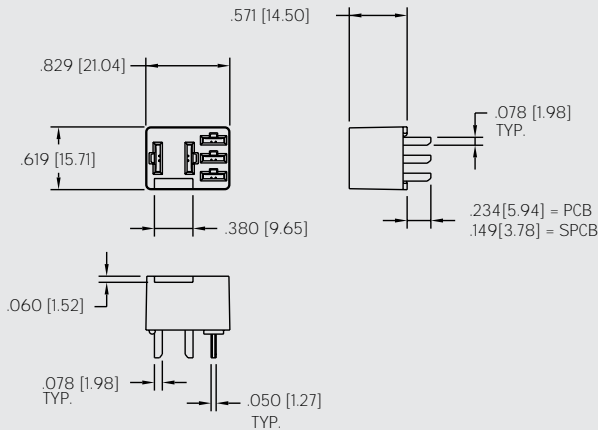
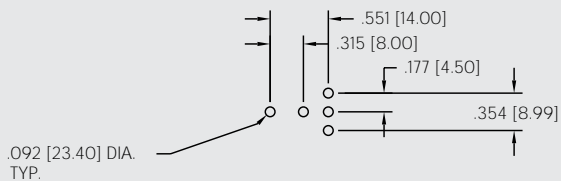

Fig. 3

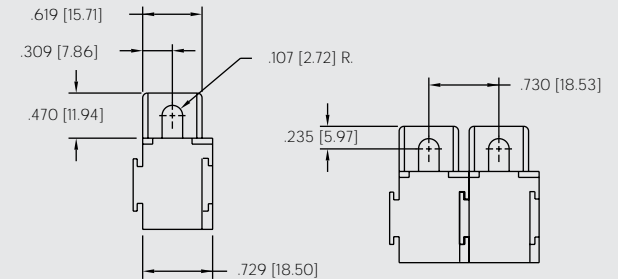
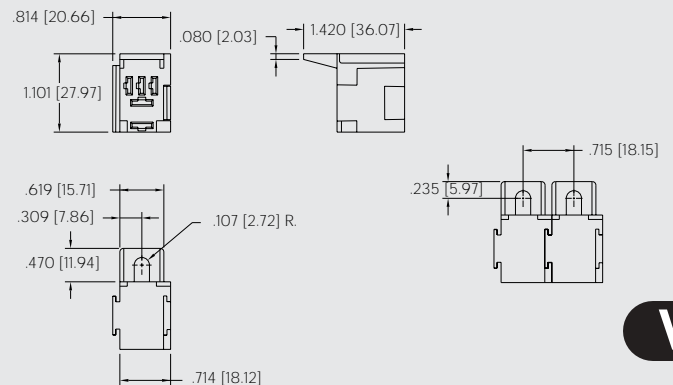

Fig. 4



VR