

# Greenwich Electronics, Inc.

## LS4 Series

- Ultra small size
- High switching capacity
- High sensitivity coil available
- Approvals: us pending
- Applications: telecommunications, home audio/video equipment, office equipment

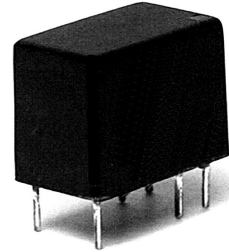

### COIL DATA

Nominal Voltage (DC)	Nominal Coil Current (mA) (± 10% at 20°C)		Coil Resistance (Ω) (± 10% at 20°C)	
	Std coil	Sensitive coil (H)	Std coil	Sensitive coil (H)
1.5	133	100	11	15
3	67	50	45	60
5	40	30	125	167
6	33	25	180	240
9	22	17	405	540
12	17	13	720	960
24	8	6	2880	3840

Pick-up Voltage	≤80% nominal
Drop-out Voltage	≥10% nominal
Max. Coil Voltage	120% nominal
Coil Consumption	<b>Std:</b> Approx. 0.2W, <b>H:</b> Approx. 0.15W

### Contact

Configuration	<b>A:</b> 1 form A (SPST-NO), <b>C:</b> 1 form C (SPDT)
Material	Silver (Ag) alloy
Rated Load	1A@24VDC, 0.5A@125VAC
Max. Carry Current	1A
Max. Switching Voltage	60VDC / 125VAC
Max. Switching Current	1A
Max. Switching Power	30W / 63VA

# Greenwich Electronics, Inc.

## CHARACTERISTICS

Contact Resistance	Max. 100m $\Omega$ (Measured at 1A 6VDC)
Operate Time	$\leq$ 5ms
Release Time	$\leq$ 5ms
Insulation Resistance	1000M $\Omega$ (@500VDC)
Dielectric Strength:	
• Between coil and contacts	1000VAC - 50Hz / one minute
• Between open contacts	400VAC - 50Hz / one minute
Vibration Resistance	10-55Hz, 3.3mm, double amplitude
Shock Resistance	10m/s <sup>2</sup>
Ambient Temperature	
• Operate	-30°C to +70°C
• Storage	-30°C to +125°C
Relative Humidity	35% - 85%
Life Expectancy:	
• Mechanical	5 x 10 <sup>6</sup> (3600 ops/hr)
• Electrical	1 x 10 <sup>5</sup> (1800 ops/hr)
Weight	Approx. 2.2 grams

## ORDERING INFORMATION

	<u>LS4</u>	-	<u>XXX</u>	-	<u>A</u>	<u>H</u>	<u>D</u>
	I		II		III	IV	V
I.	Series				<b>LS4</b>		
II.	Coil Voltage (VDC)				<b>001, 003, 005, 006, 009, 012, 024</b>		
III.	Contact Configuration				<b>A - 1 form A (SPST-NO), C - 1 form C (SPDT)</b>		
IV.	Coil Sensitivity				<b>nil - Standard, H - High Sensitivity</b>		
V.	Package Type				<b>D - Dust Cover, S - Sealed</b>		

# Greenwich Electronics, Inc.

## LS4 Series Dimensions and Schematics (in mm)

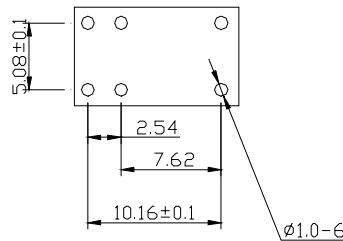
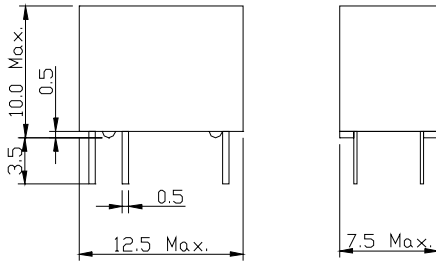

### Terminal arrangement and wiring diagram

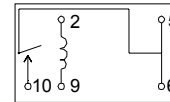

SPST-NO - 1 form A

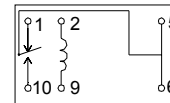

SPDT - 1 form C